

DALMATIC EDDY CURRENT BRAKE TYPE JE3-8

OPERATING DESCRIPTION

The Fire Roller Gate is held open by an electric magnet.
By signal from the fire alarm or by power failure the magnet is disconnected,
and the gate closes by a counter weight or similar.

The Eddy Current Brake limits the closing speed and no danger
arises during this operation.

The built-in freewheeling disconnects the brake
when the door opens again manual/automatic.

As the Eddy Current Brake works by permanent magnets,
and not by friction, the brake capability will never wear out.

Item no: 90000990

Registered Design 86.0641

DIMENSIONS

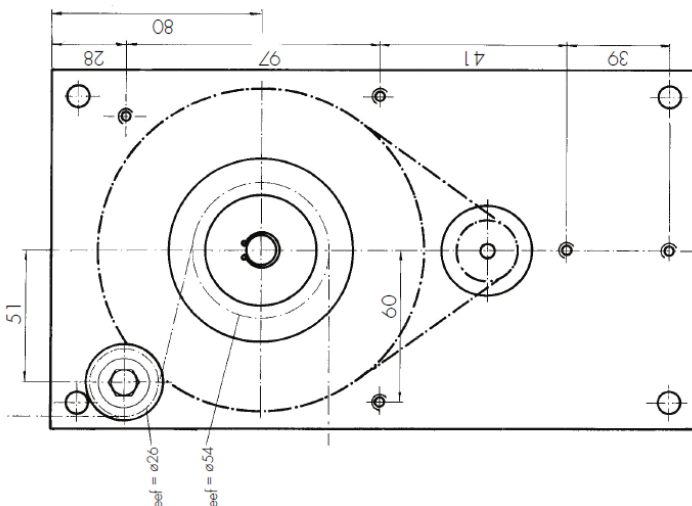
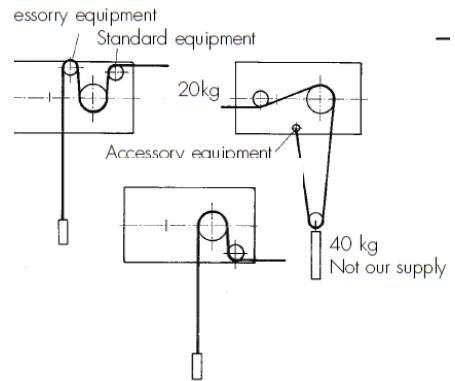
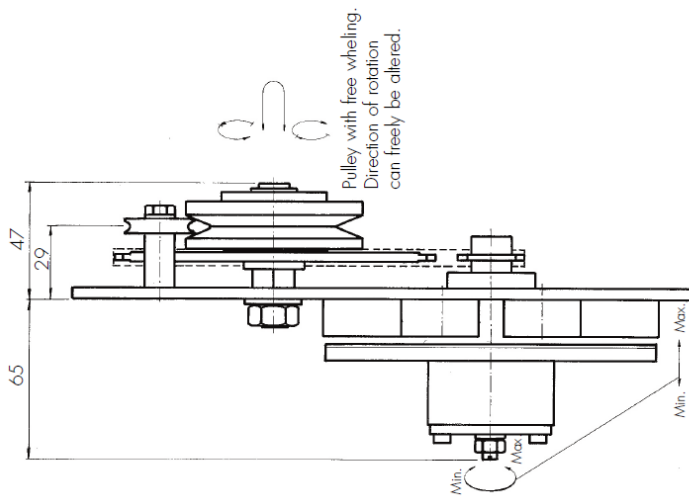
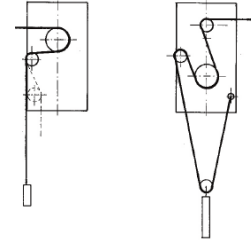
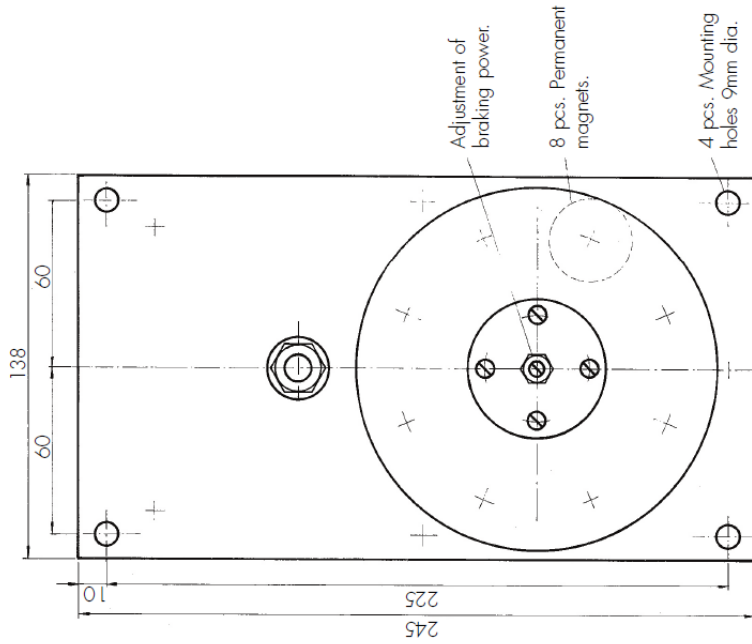

Examples of mounting

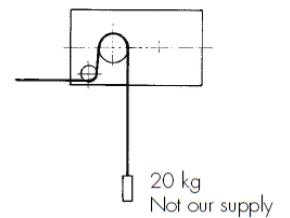

Item no: 9000990

Registered Design 86.0641